

GUANGZHOU HAOQING MOTOR CO.,LTD

YGP Series Inverter and Vector Induction Motors for Roller Table



- Frame sizes: 112-400
- Rated output: 1.1-250Kw
- Voltage: 380V Frequency range: 5- 100Hz
- Duty Cycle: S5 FC: 60%
- Degree of protection: IP54 / IP55
- Insulation class: F, H Poles : 4,6,8

Applications: Widely used for the metallurgy equipment, especially the ones which are controlled by variable frequency system. The motor suits not only for live roll table of S1 duty mode but also for the work roll table of periodic operation, frequent start and stop, positive and reversal rotation.

Features: Good overload capacity and mechanic strength, wide range of speed regulation, smooth operation.

Performance Data

380V 50Hz

Model	Output kW	FLA	FLT N.m	RPM	$\frac{LRT}{FLT}$ $\frac{Tst}{T_N}$	$\frac{BDT}{FLT}$ $\frac{T_{max}}{T_N}$	Rotor inertia kg.m ²
Synchronous speed 1500r/min							
YGP100L-4	0.75	1.8	5	1440	1.3~2.0	3.7	0.0092
YGP112L1-4	1.1	2.4	7.3	1450	1.3~2.0	3.6	0.0124
YGP112L2-4	1.5	3.0	10	1450	1.3~2.0	3.6	0.0173
YGP132M1-4	2.2	4.6	14.5	1450	1.3~2.0	3.5	0.0254
YGP132M2-4	3	6.1	20	1450	1.3~2.0	3.5	0.0382
YGP160S1-4	4	8.0	26.2	1460	1.3~2.0	3.6	0.0785
YGP160S2-4	5.5	11	36	1460	1.3~2.0	3.6	0.0826
YGP160L1-4	6.3	12.3	41.2	1460	1.3~2.0	3.7	0.102
YGP160L2-4	7.5	14.5	49.1	1460	1.3~2.0	3.7	0.125
YGP180L1-4	9	17.0	58.7	1465	1.3~2.0	3.7	0.152
YGP180L2-4	11	20.5	71.7	1465	1.3~2.0	3.7	0.178
YGP200L1-4	15	28.0	97.8	1465	1.3~2.0	3.8	0.265
YGP200L2-4	18.5	33.4	120.6	1465	1.3~2.0	3.8	0.356
YGP225M1-4	22	39.6	142.5	1475	1.3~2.0	3.8	0.411
YGP225M2-4	25	44.5	162	1475	1.3~2.0	3.7	0.483
Synchronous speed 1000r/min							
YGP112L1-6	0.75	2.0	7.4	965	1.3~2.0	3.6	0.0112
YGP112L2-6	1.1	2.7	11	965	1.3~2.0	3.6	0.0116
YGP132M1-6	1.5	3.4	15	965	1.3~2.0	3.2	0.0264
YGP132M2-6	2.2	4.8	22	965	1.3~2.0	3.2	0.0426
YGP160S1-6	3	6.6	29.5	970	1.3~2.0	3.4	0.0857
YGP160S2-6	4	8.7	39.4	970	1.3~2.0	3.4	0.0934
YGP160L1-6	5.5	11.7	54	970	1.3~2.0	3.6	0.115
YGP160L2-6	6.3	13.2	62	970	1.3~2.0	3.5	0.159

GUANGZHOU HAOQING MOTOR CO.,LTD

Performance Data

380V 50Hz

Model	Output kW	FLA	FLT N.m	RPM	$\frac{LRT}{FLT}$ $\frac{T_{st}}{T_N}$	$\frac{BDT}{FLT}$ $\frac{T_{max}}{T_N}$	Rotor inertia kg.m ²
Synchronous speed 1000r/min							
YGP180L1-6	7.5	15.0	73.5	975	1.3~2.0	3.6	0.203
YGP180L2-6	9	17.7	88.1	975	1.3~2.0	3.6	0.287
YGP200L1-6	11	21.7	107.8	975	1.3~2.0	3.7	0.312
YGP200L2-6	15	28.6	147	975	1.3~2.0	3.7	0.383
YGP225M1-6	18.5	34.4	181	975	1.3~2.0	3.5	0.524
YGP225M2-6	22	41.0	215	975	1.3~2.0	3.5	0.623
Synchronous speed 750r/min							
YGP112L1-8	0.55	1.6	7.3	725	1.3~2.0	3.5	0.0112
YGP112L2-8	0.75	2.0	10	725	1.3~2.0	3.5	0.0166
YGP132M1-8	1.1	3.2	14.5	725	1.3~2.0	3.2	0.0264
YGP132M2-8	1.5	4.3	20	725	1.3~2.0	3.2	0.0426
YGP160S1-8	2.2	5.5	30	725	1.3~2.0	3.5	0.0857
YGP160S2-8	3	7.3	39.5	725	1.3~2.0	3.5	0.0945
YGP160L1-8	4	9.6	52.7	725	1.3~2.0	3.6	0.121
YGP160L2-8	5.5	13.0	72.5	725	1.3~2.0	3.6	0.196
YGP180L1-8	6.3	15.0	82.4	730	1.3~2.0	3.6	0.238
YGP180L2-8	7.5	17.0	98	730	1.3~2.0	3.5	0.297
YGP200L1-8	9	20.0	117.7	730	1.3~2.0	3.6	0.315
YGP200L2-8	11	25.0	144	730	1.3~2.0	3.7	0.341
YGP225M1-8	15	31.7	195	735	1.3~2.0	3.6	0.524
YGP225M2-8	18.5	38.5	240	735	1.3~2.0	3.6	0.623

Note: The ratio value of the $\frac{LRT}{FLT}$ is calculated under the condition that the frequency is 3Hz, and the value is determined by the control mode of inverter. The ratio of the $\frac{BDT}{FLT}$ is calculated under the condition of 50Hz frequency.

Technical Characteristics

This series motor is of F or H insulation grade, IP54 protection (motor of IP55、IP56 can also be customized), IC410 cooling method. Wide frequency range 5~100Hz, of which 5~50Hz is for maintaining constant torque and 50~100Hz is for constant output. With good overload capability the motor can work with overload of 3.5~4.0 times of rated torque (general purpose motor can bear about 2 times). This series motors have good performance at low speed. The starting torque at 5Hz is 1.3~1.8 times of its rated value.

GUANGZHOU HAOQING MOTOR CO.,LTD

Dimensions & Mounting

mm

B3 (Horizontal Foot Mounted Only)

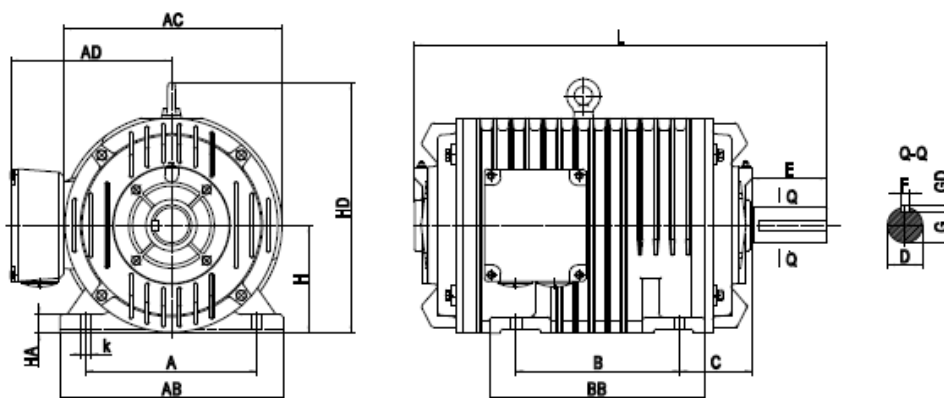

Frame	Mounting Dimension										Overall Dimension					
	A	B	C	D	E	F	G	GD	H	K	AB	AC	BB	HA	HD	L
112L	190	159	70	32	80	10	27	8	112	12	235	240	200	20	330	460
132M	216	178	89	38	80	10	33	8	132	12	265	265	236	23	355	520
160S	254	178	108	48	110	14	42.5	9	160	15	315	315	236	25	410	650
160L	254	254	108	48	110	14	42.5	9	160	15	315	315	310	25	410	700
180L	279	279	121	55	110	16	49	10	180	15	360	360	350	30	500	750
200L	318	305	133	65	140	18	58	11	200	19	415	415	400	35	570	860
225M	356	311	149	75	140	20	67.5	12	225	19	470	470	415	35	620	950

B5 (Footless and B5 Flange Mounted)

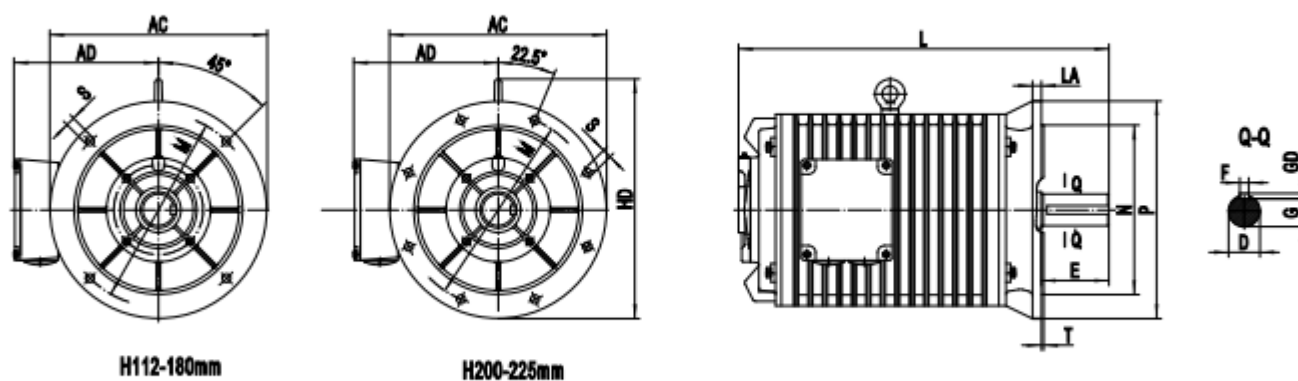

Frame	Flange	Mounting Dimension												Overall Dimension			
		D	E	F	G	GD	M	N	P	R	S	T	Holes	AC	HD	LA	L
112L	FF215	32	80	10	27	8	215	180	250	0	15	4	4	250	330	12	460
132M	FF265	38	80	10	33	8	265	230	300	0	15	4	4	300	355	12	520
160S	FF300	48	110	14	42.5	9	300	250	350	0	19	5	4	350	410	14	650
160L	FF300	48	110	14	42.5	9	300	250	350	0	19	5	4	350	410	14	700

GUANGZHOU HAOQING MOTOR CO.,LTD

180L	FF300	55	110	16	49	10	300	250	350	0	19	5	4	360	500	16	750
200L	FF400	65	140	18	58	11	400	350	450	0	19	5	8	450	570	18	860
225M	FF400	75	140	20	67.5	12	400	350	450	0	19	5	8	470	620	18	950

B35 (Foot and B5 Flange Mounted)

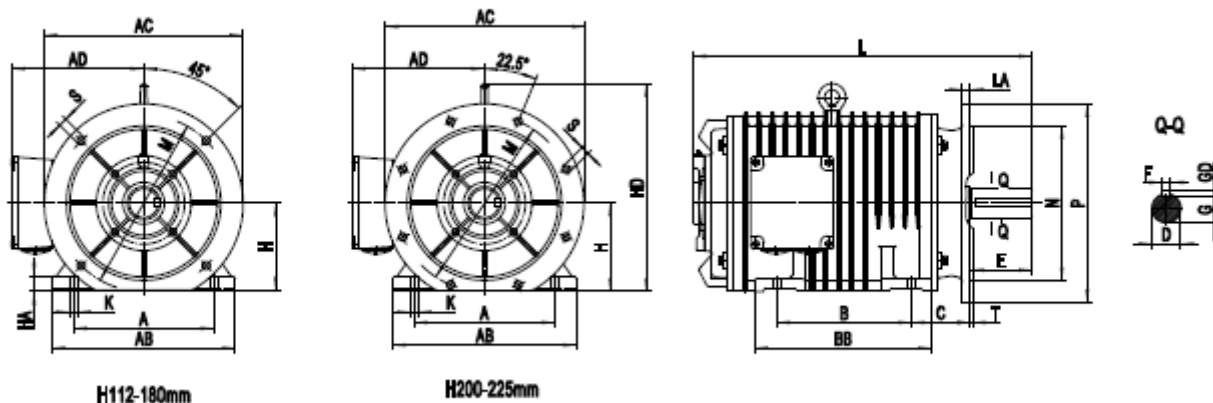

Frame	Flange	Mounting Dimension															Overall Dimension							
		A	B	C	D	E	F	G	H	K	M	N	P	R	S	T	Hole s	AB	AC	BB	HA	HD	LA	L
112L	FF215	190	159	70	32	80	10	27	112	12	215	180	250	0	15	4	4	235	250	200	20	330	12	460
132M	FF265	216	178	89	38	80	10	33	132	12	265	230	300	0	15	4	4	265	300	236	23	355	12	520
160S	FF300	254	178	108	48	110	14	42.5	160	15	300	250	350	0	19	5	4	315	350	236	25	410	14	650
160L	FF300	254	254	108	48	110	14	42.5	160	15	300	250	350	0	19	5	4	315	350	310	25	410	14	700
180L	FF300	279	279	121	55	110	16	49	180	15	300	250	350	0	19	5	4	360	360	350	30	500	16	750
200L	FF400	318	305	133	65	140	18	58	200	19	400	350	450	0	19	5	8	415	450	400	35	570	18	860
225M	FF400	356	311	149	75	140	20	67.5	225	19	400	350	450	0	19	5	8	470	470	415	35	620	18	950

Data above may be changed without prior notice.